

window installation with windproofing,  
airproofing and fixation according to  
specifications of the window manufacturer

interior works not displayed

gradient  $\geq 5^\circ$

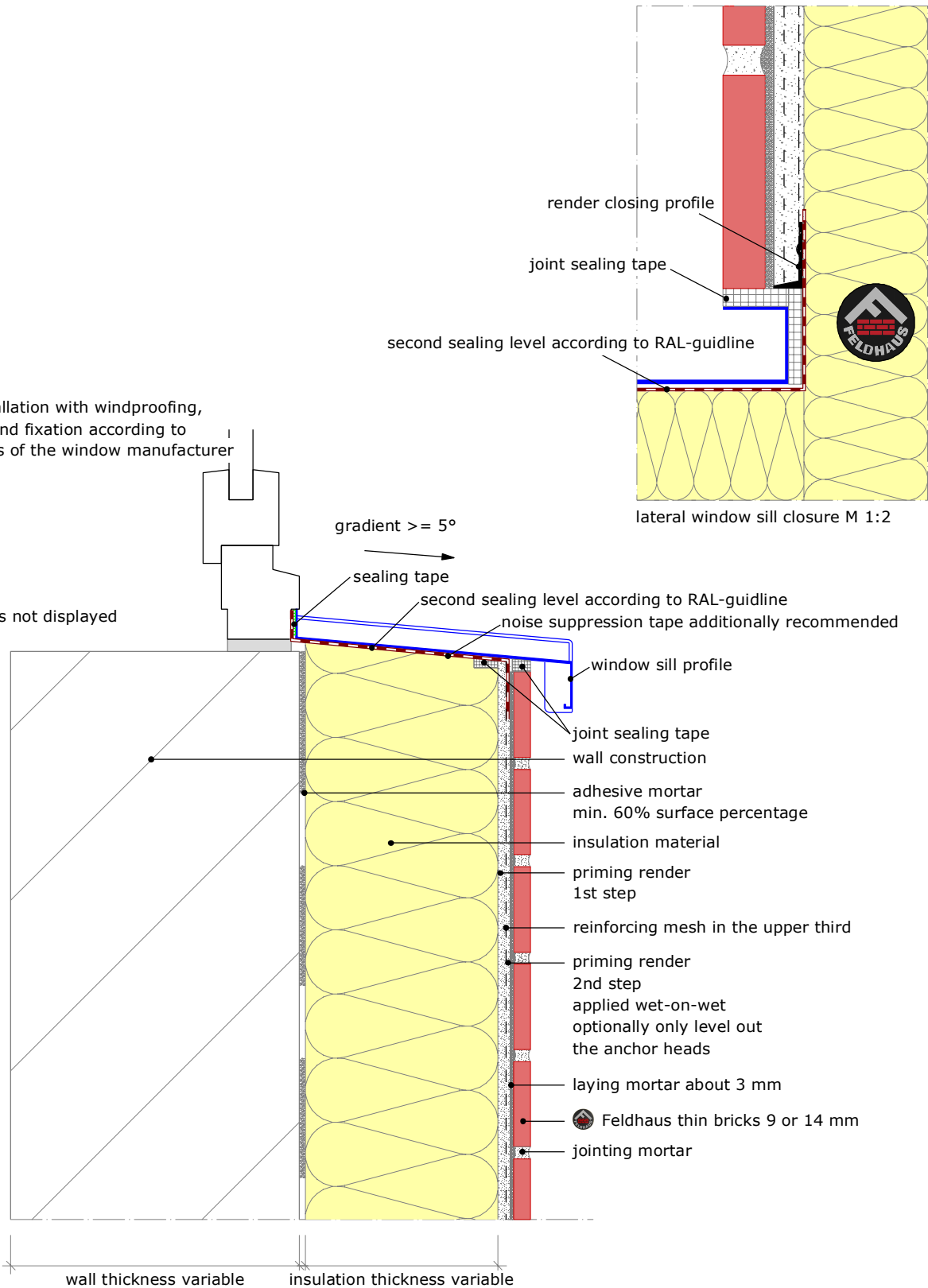

**Note:**

This detail is a general proposition which schematically shows a possible execution. Usability and completeness are to be checked under personal responsibility regarding the particular construction project.

Related works are only shown schematically.

The specifications of corresponding standards, relevant system authorisations and data sheets are to be respected. All specifications and assumptions are to be customised to local conditions.



Feldhaus Klinker Vertriebs-GmbH  
Nordring 1, 49196 Bad Laer  
Zentrale +49 (0) 54 24 29 20 0

[www.feldhaus-klinker.de](http://www.feldhaus-klinker.de)

**Content window breast**

with window sill profile, flush with masonry  
vertical cut

M 1:5 sheet FH\_EN\_V\_thinbr-windowbreast1